

base cabinets — corrosives & flammables

Corrosives storage cabinets are reinforced steel with a hi-tech performance polymer alloy coating, which provides 100% coverage against corrosion. Cabinets are available in 18" and 22" depths. For 22" depth, add suffix "-22" to the part number.

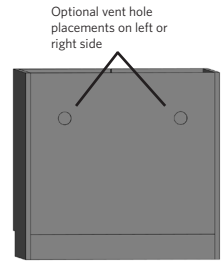

corrosives storage cabinets

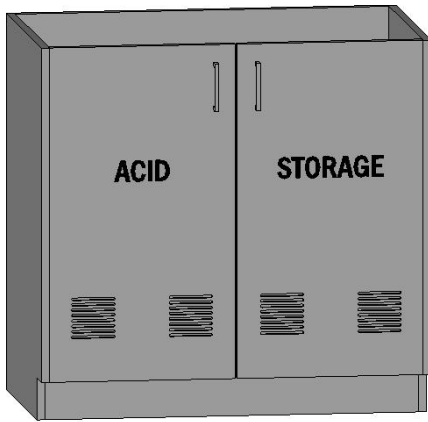

Width	Sitting Height	ADA Height	Standing Height
18"	SASB2918-100	SASB3218-100	SASB3518-100
24"	SASB2924-100	SASB3224-100	SASB3524-100
30"	SASB2930-200	SASB3230-200	SASB3530-200
36"	SASB2936-200	SASB3236-200	SASB3536-200
42"	SASB2942-200	SASB3242-200	SASB3542-200
48"	SASB2948-200	SASB3248-200	SASB3548-200
52"	SASB2952-200	SASB3252-200	SASB3552-200
58"	SASB2958-200	SASB3258-200	SASB3558-200

When ordering 18" or 24" wide cabinets please place suffix "L" left or "R" right, after the part number for the hinge placement. If a Vent Kit is required, use the suffix "VK".

Note: AMS recommends vent kits for all corrosives cabinets. Acids and bases should not be stored in the same cabinet.

Flammables storage cabinets are certified to meet NFPA 45 and are UL listed. Cabinets are available in 18" and 22" depths. For 22" depth, add suffix "-22" to the part number. For synchronized self-closing doors add "-SCC" to the part number.

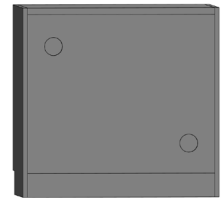

flammables storage cabinets



Width	Sitting Height	ADA Height	Standing Height
18"	SFSB2918-100	SFSB3218-100	SFSB3518-100
24"	SFSB2924-100	SFSB3224-100	SFSB3524-100
30"	SFSB2930-200	SFSB3230-200	SFSB3530-200
36"	SFSB2936-200	SFSB3236-200	SFSB3536-200
42"	SFSB2942-200	SFSB3242-200	SFSB3542-200
48"	SFSB2948-200	SFSB3248-200	SFSB3548-200
52"	SFSB2952-200	SFSB3252-200	SFSB3552-200
58"	SFSB2958-200	SFSB3258-200	SFSB3558-200

Mobile cabinets are available. Please contact your AMS representative.

Vacuum Pump Cabinets

Vacuum Pump Cabinets come with a neoprene sound deadener applied to the inside of the cabinet. (Please note actual cabinet depth with finished back will be 22.875" and 18.875").

Vent pipe as shown is not included

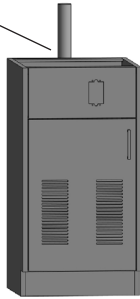

Vent pipe as shown is not included

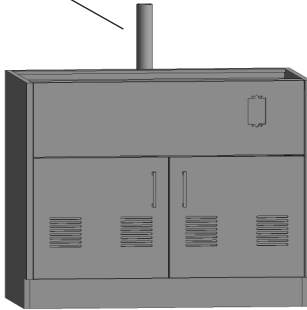

Vent pipe as shown is not included

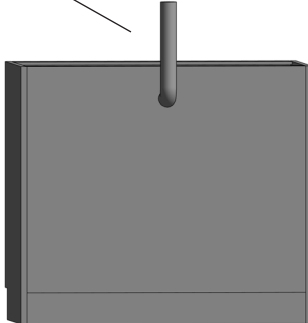

Vent pipe as shown is not included

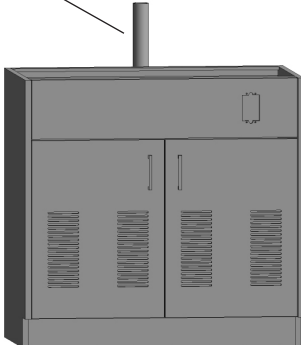

Width	Item Number
15"	SB3515-10V
18"	SB3518-10V
21"	SB3521-10V
24"	SB3524-10V

When ordering 18" or 24" wide cabinets please place suffix "L" left or "R" right, after the part number for the hinge placement.

Attention: All of these units are shipped with a loose unassembled junction box, switch and wiring. These are to be installed by your certified electrician.

Width	Item Number
30"	SB2930-20V-18
36"	SB2936-20V-18
42"	SB2942-20V-18
48"	SB2948-20V-18

Width	Item Number
30"	SB2930-20V
36"	SB2936-20V
42"	SB2942-20V
48"	SB2948-20V

Width	Item Number
30"	SB3230-20V-18
36"	SB3236-20V-18
42"	SB3242-20V-18
48"	SB3248-20V-18

Width	Item Number
30"	SB3230-20V
36"	SB3236-20V
42"	SB3242-20V
48"	SB3248-20V

Width	Item Number
30"	SB3530-20V-18
36"	SB3536-20V-18
42"	SB3542-20V-18
48"	SB3548-20V-18

Width	Item Number
30"	SB3530-20V
36"	SB3536-20V
42"	SB3542-20V
48"	SB3548-20V

Vacuum Pump Cabinets

Vacuum Pump Cabinets come with a neoprene sound deadener applied to the inside of the cabinet. (Please note actual cabinet depth with finished back will be 22.875" and 18.875")

Vent pipe as shown is not included

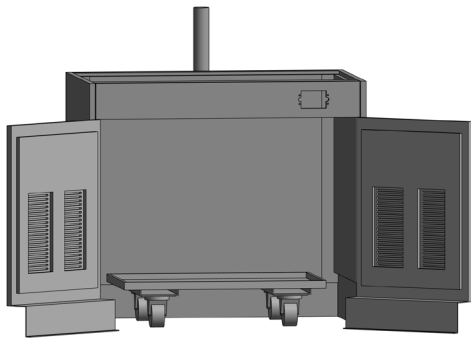
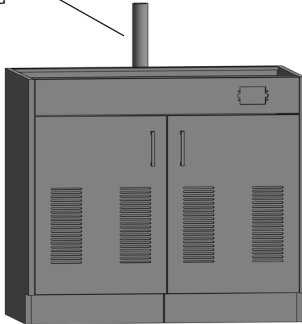

Attention: These units are shipped with a loose unassembled junction box, switch and wiring. These are to be installed by your certified electrician.

These units include the cart pictured as part of the unit price. Vent pipe is not included.

Width	Item Number
30"	SB2930-20V-18-NB
36"	SB2936-20V-18-NB
42"	SB2942-20V-18-NB
48"	SB2948-20V-18-NB

Width	Item Number
30"	SB2930-20V-NB
36"	SB2936-20V-NB
42"	SB2942-20V-NB
48"	SB2948-20V-NB

Width	Item Number
30"	SB3230-20V-18-NB
36"	SB3236-20V-18-NB
42"	SB3242-20V-18-NB
48"	SB3248-20V-18-NB

Width	Item Number
30"	SB3230-20V-NB
36"	SB3236-20V-NB
42"	SB3242-20V-NB
48"	SB3248-20V-NB

Width	Item Number
30"	SB3530-20V-18-NB
36"	SB3536-20V-18-NB
42"	SB3542-20V-18-NB
48"	SB3548-20V-18-NB

Width	Item Number
30"	SB3530-20V-NB
36"	SB3536-20V-NB
42"	SB3542-20V-NB
48"	SB3548-20V-NB

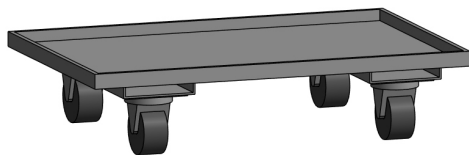

Width	Item Number
24"	MOBILE-CART-24
36"	MOBILE-CART-36

(Standard depth of 22")

Width	Item Number
24"	MOBILE-CART-24-18
36"	MOBILE-CART-36-18

(Suffix 18 represents 18" depth)